



STEELHAUS

Creative | Strong | Cost Effective

EZYJOIST™

STEEL FLOOR JOIST SYSTEM



LONGER SPANS
LIGHTER WEIGHT
FASTER INSTALL

Introducing EZYJOIST® a New Zealand made and manufactured, engineered Floor Joist for use in both residential and commercial construction.

The future of pre planned construction has arrived and Steelhaus is at the forefront of this industry. We have been manufacturing in New Zealand for over 6 years for local conditions and specifiers who trust our pre planned, pre punched and pre assembled frames and joists.

EZYJOIST BENEFITS:

- Spans of 7.25m at 1.5KPa and 6.1m at 5KPa floor loads. Our system allows you to maximise the open plan spaces within the building and can reduce the number of pile supports required for the sub floor.
- With 4 different EZYJOIST sizes to suit your needs, they are light weight and easy to install.
- Supplied cut to length ready to install, with Joist locating Tabs at the required spacing, pre punched 140mm diameter service penetrations, bolt holes for back to back fixing. Pre planning reduces onsite labour hours and extra bracketry required on site.

- Easily connect to timber, concrete and steel wall structures
- Compatible with all floor board types including particle board, plywood, strand floor, OSB, aerated concrete and fibre cement.
- Mid span and bracing blocking details are simple and easy to install and make council pre inspection a breeze.
- Pre Engineered Span Tables allow ease of specification at the design stage. We provide a PS1 with all floors for consent.
- One hour fire rating using GIB Fire Rated Floor/Ceiling Systems.
- Acoustic ratings achieved using the GIB Noise Control Systems Manual.

When you consider span capability and ease of install EZYJOIST is the most cost effective floor joist system on the market.

LOAD BEARING WALL HOLD DOWN (WALL BETWEEN JOISTS)

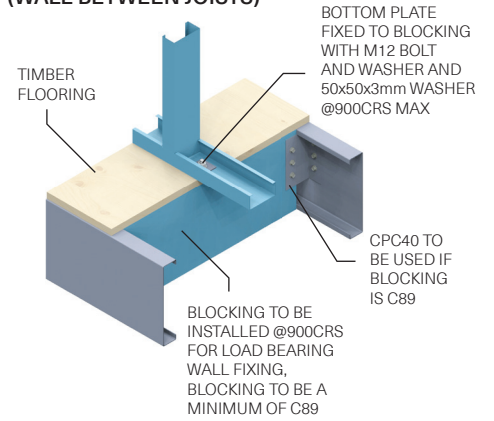

TABBED CONNECTION

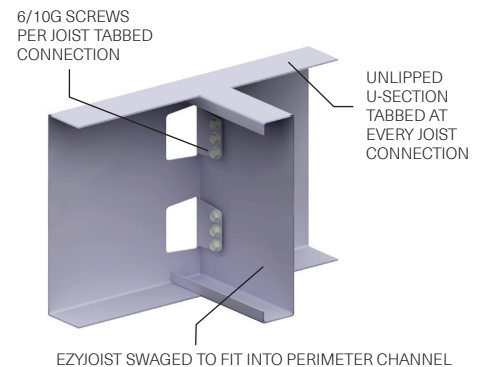

TECHNICAL

Connection details available in our Construction Manual. Download from www.steelhaus.co.nz/steel-buildings-nz

WHY STEEL

VISIT: www.steelhaus.co.nz/steel-construction-nz

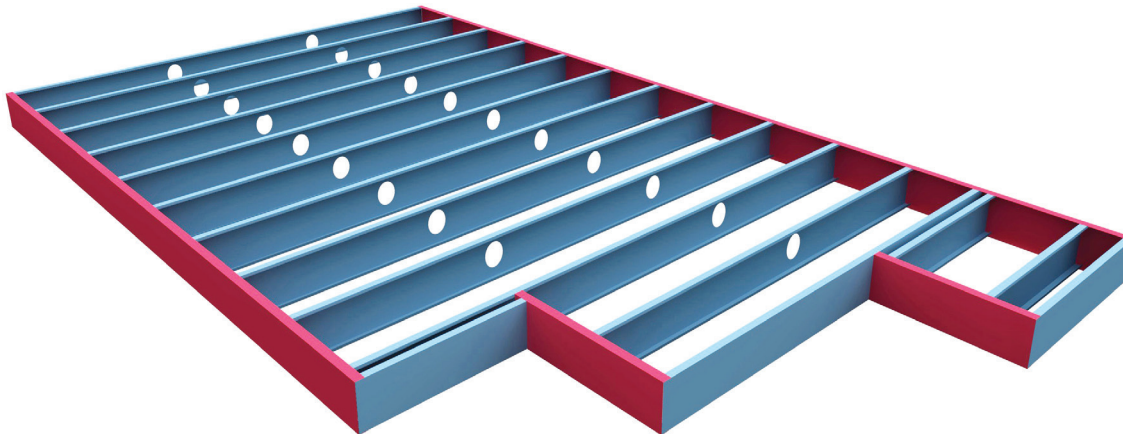

MID FLOOR JOIST OVER LOAD BEARING WALL

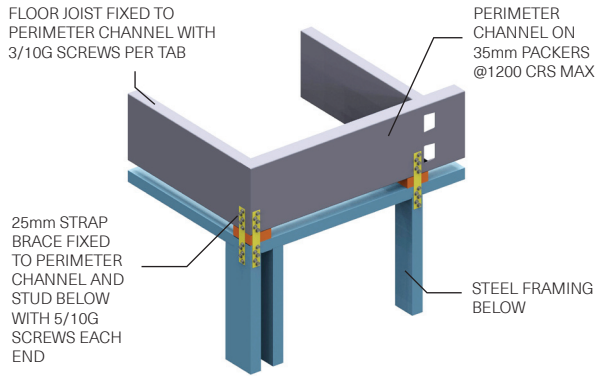

MID FLOOR PERIMETER CHANNEL FIXED TO STRUCTURAL BEAM

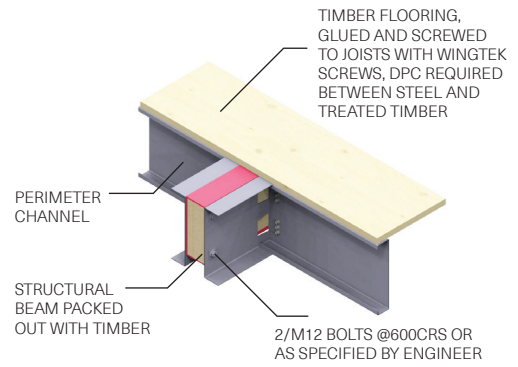

MID FLOOR JOIST OVER LOAD BEARING WALL

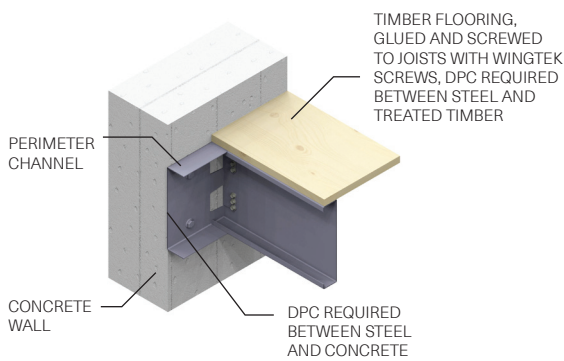

MID-SPAN STRAP BRACING

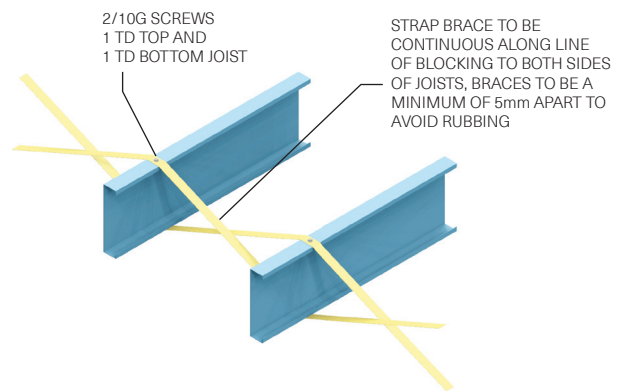

EZYJOIST SIZES								
Profile	W	F	SH1	SH2	Penetration with Strengthening	TAB QTY	G	Material
EJ150x45x1.55mm	150mm	45mm	NA	34mm	80mm	1	1.55mm	G250 Z275 Galv
EP150x60x1.55mm	150mm	58mm	NA	34mm	80mm	1	1.55mm	G250 Z275 Galv
EJ190x45x1.55mm	190mm	45mm	90mm	34mm	130mm	1	1.55mm	G250 Z275 Galv
EP190x60x1.55mm	190mm	58mm	90mm	34mm	130mm	1	1.55mm	G250 Z275 Galv
EJ240x45x1.15mm	190mm	45mm	140mm	34mm	150mm	2	1.15mm	G250 Z275 Galv
EP240x60x1.15mm	190mm	58mm	140mm	34mm	150mm	2	1.15mm	G250 Z275 Galv
EJ240x45x1.55mm	240mm	45mm	140mm	34mm	150mm	2	1.55mm	G250 Z275 Galv
EP240x60x1.55mm	240mm	58mm	140mm	34mm	150mm	2	1.55mm	G250 Z275 Galv
EJ240x45x1.95mm	240mm	45mm	140mm	34mm	150mm	2	1.95mm	G250 Z275 Galv
EP240x60x1.95mm	240mm	58mm	140mm	34mm	150mm	2	1.95mm	G250 Z275 Galv
EJ290x45x2.5mm	290mm	45mm	140mm	34mm	150mm	2	2.5mm	G250 Z275 Galv
EP290x58x2.5mm	290mm	58mm	140mm	34mm	150mm	2	2.5mm	G250 Z275 Galv

FLOOR JOIST (EJ) PROFILE

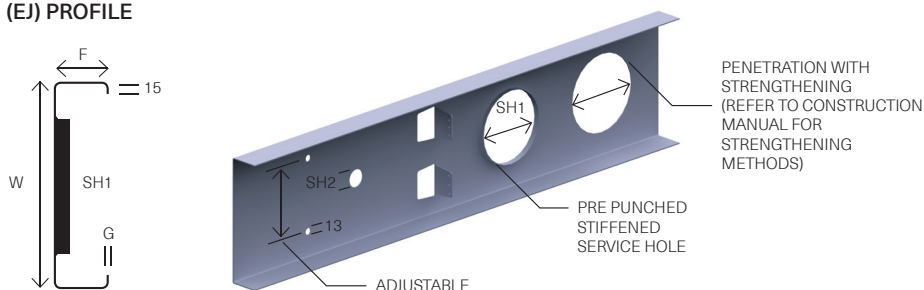

PERIMETER CHANNEL (EP) PROFILE

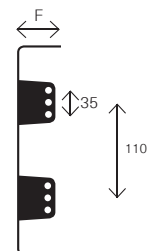



> LIGHTER, STRONGER AND EASIER TO INSTALL



> SPECIFIERS AND BUILDERS CHOOSE EZYOIST



> UP TO 7.25 METER SPANS OPENING UP ROOM DESIGN

Max joist span for 1.5kPa (residential) live load & 0.5kPa dead load (typically timber flooring with carpet & gib ceiling on battens)									
Profile	Web (mm)	Flange (mm)	Lip (mm)	Material Thickness (mm)	Max Hole Diameter (mm)	Minimum Hole Spacing (mm)	Max Span (mm)		
							400cts	450cts	600cts
FJ150x1.55	150	45	16	1.55	32	1000	3650	3650	3300
FJ190x1.55	190	45	16	1.55	90	1000	4400	4400	4050
FJ240x1.15	240	45	16	1.15	140	1000	4850	4850	4200
FJ240x1.55	240	45	16	1.55	140	1000	5350	5350	5000
FJ240x1.95	240	45	16	1.95	140	1000	5750	5750	5450
FJ290x2.50	290	45	16	2.5	140	1000	7250	7250	7050

Max joist span for 3.0kPa (offices) live load & 0.5kPa dead load (typically timber flooring with carpet & gib ceiling on battens)									
Profile	Web (mm)	Flange (mm)	Lip (mm)	Material Thickness (mm)	Max Hole Diameter (mm)	Minimum Hole Spacing (mm)	Max Span (mm)		
							400cts	450cts	600cts
FJ150x1.55	150	45	16	1.55	32	1000	3650	3600	3150
FJ190x1.55	190	45	16	1.55	90	1000	4400	4150	3600
FJ240x1.15	240	45	16	1.15	140	1000	3850	3600	3100
FJ240x1.55	240	45	16	1.55	140	1000	5000	4700	4100
FJ240x1.95	240	45	16	1.95	140	1000	5750	5500	4800
FJ290x2.50	290	45	16	2.5	140	1000	7200	7000	6250

Max joist span for 5.0kPa (storage) live load & 0.5kPa dead load (typically timber flooring with carpet & gib ceiling on battens)									
Profile	Web (mm)	Flange (mm)	Lip (mm)	Material Thickness (mm)	Max Hole Diameter (mm)	Minimum Hole Spacing (mm)	Max Span (mm)		
							400cts	450cts	600cts
FJ150x1.55	150	45	16	1.55	32	1000	3050	3900	2500
FJ190x1.55	190	45	16	1.55	90	1000	3500	3300	2850
FJ240x1.15	240	45	16	1.15	140	1000	3050	2850	2450
FJ240x1.55	240	45	16	1.55	140	1000	3950	3750	3250
FJ240x1.95	240	45	16	1.95	140	1000	4650	4400	3800
FJ290x2.50	290	45	16	2.5	140	1000	6100	5750	4950



Steelhaus is proud to be associated with and stand alongside these trusted industry names. As chartered members of the **Sustainable Steel Council** we are fully committed to a cleaner, more efficient industry and support New Zealand's low emissions future.



STEELHAUS

Creative | Strong | Cost Effective

Free Call **0508 826 766**

E: sales@steelhaus.co.nz www.steelhaus.co.nz